

HYDRAULIC CYLINDERS

UPDATE 03/24

We have a horse in every race

The CHARVÁT Group and its subsidiaries offer a complete range of components for the construction of hydraulic systems.



ABOUT US

Headquarters: Zbraslavice, Kutná Hora

Establishment: 1998

Turnover: 110 mil EUR

Employees: over 1000

Hydraulic system:

- ❖ Hydraulic cylinders
- ❖ Manipulated tubes
- ❖ Hydraulic components
- ❖ Assembled hoses
- ❖ Power packs

Special products:

- ❖ Hook lifts systems
- ❖ Aircraft undercarriages

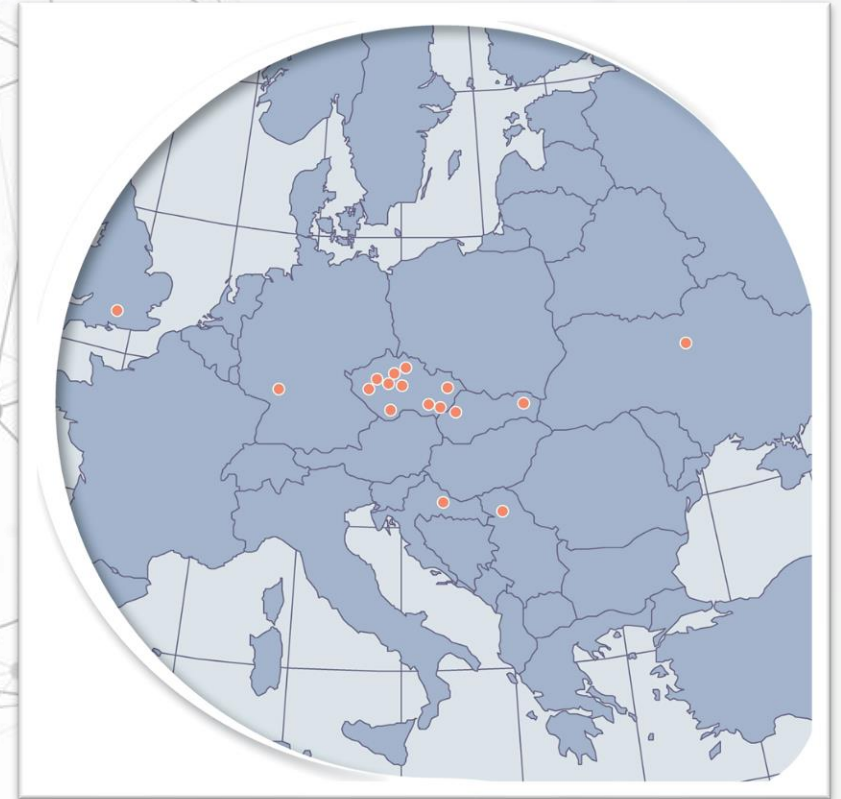

The CHARVÁT Group and its subsidiaries offer a complete range of components for the construction of hydraulic systems and landing gears.

Production locations and branches

**HYDRAULIC
CYLINDERS**



**HYDRAULIC HOSES
BENDED PIPES
FASTENERS**



**CONTAINER
LIFTS**



**HYDRAULIC
POWER UNITS**

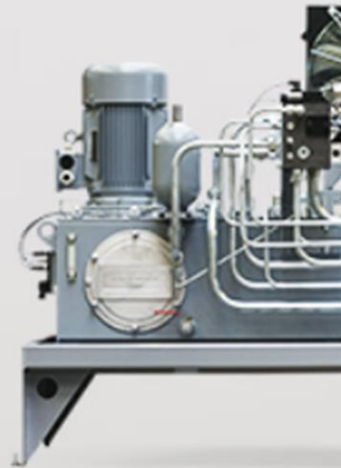

**INDUSTRIAL
FLUIDS**



**AIRCRAFT
UNDERCARRIAGE**

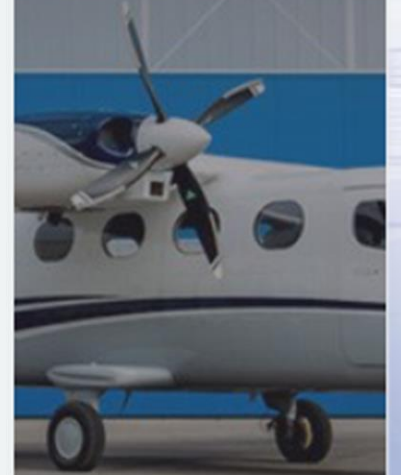

PRODUCTION PLANTS



CHARVÁT Group Zbraslavice

1998

- ❖ Small and middle series of hydraulic cylinders up to piston diameter 100 mm
 - ❖ Hydraulic hoses
 - ❖ Manipulated tubes



CHARVÁT Group Opava

2006

- ❖ Hydraulic hoses
- ❖ Fittings production
- ❖ Hydraulic power packs



CHARVÁT AXL Semily

2010

- ❖ Large and special hydraulic cylinders from piston diameter 100 mm up to 450 mm
 - ❖ Aircraft undercarriages

PRODUCTION PLANTS



CHARVÁT HYKOM Rakovník

2012

- ❖ Hydraulic power packs
- ❖ Hydraulic components



CHARVÁT CTS Okřínek

2013

- ❖ Hookloaders
- ❖ Skiploaders



CHARVÁT Strojárne Bardejov SK

2017

- ❖ Large series of hydraulic cylinders

PRODUCTION PLANTS



Pacovské strojírný

2023

- ❖ SHEET METAL Production
- ❖ Pharmacy, Food Industry, Beer Brewing, Chemistry & Power Industry



HYDRAULIC CYLINDERS

- Capacities more than **15.000** pcs/month
- Range the diameter of the piston up to **450** mm and the stroke up to **3.500** mm
*for the smaller piston diameters the stroke up to **5.000** mm*
*for the telescopic cylinder the stroke up to **7.000** mm*
- Application

Construction machines	Injection moulding systems
Agricultural machines	Hydraulic presses
Lifting platforms and cranes	Mining and tunneling machinery
Energy machines and turbines	Chemical, textile and food industry
Offshore applications	Metallurgical industry and steelworks

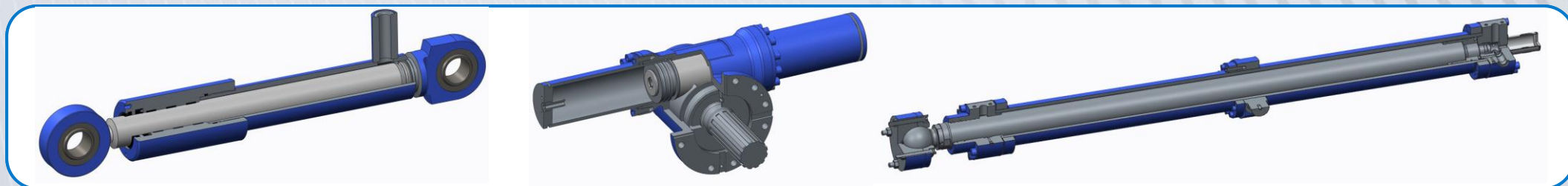

TECHNICAL PREPARATION

- **TEAM:** **42 Employees in Technology & Engineering**
- **ERP:** **HELIOS, ESO**
- partlists, material and production planning, capacity planning, backward view
- **CAD:** **SOLID WORKS**
- 3D models in STP or SAT or DXF files / strength calculations
- **CAM:** **SURF CAM**
- NC programming – fast and clever solution
- **CERTIFICATES:** **ISO 9001 and ISO 3834-2, ISO 14001, EN 15085-2, CL1**
EN 9100:2018

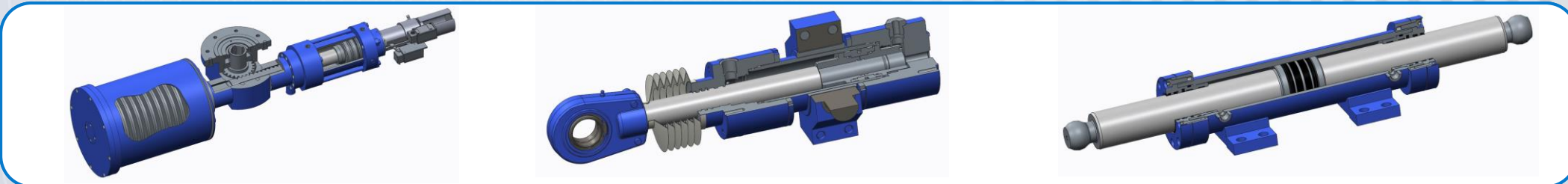
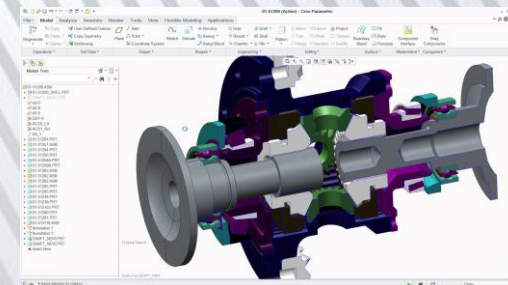
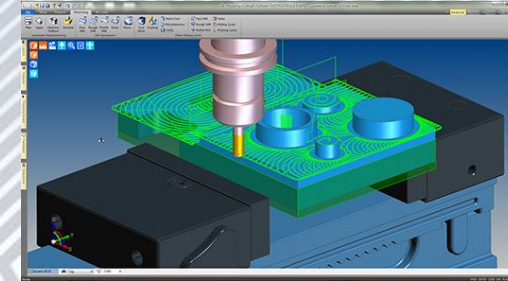

PRODUCTION

- **120 CNC and 40 conventional machines made by :** Mazak, Doosan, Mori Seiki, Gildemaister, CMZ Tajmac ZPS, Pinnacle, Leadwell



PRODUCTION

- Finishing machines (grinding machines, honing machines)



Precise surfaces, Roughness and Integrity

PRODUCTION

- Special processes (welding, heat treatment, chrome plating, painting)



**Hardening
Cementation
Annealing
Tempering**

**Welding robots &
Automatic welding
machines**

Modern Paint shop



PRODUCTION

- Metrology, Cleaning & Testing



100% 3D measurement
100% testing
100% cleaning per ISO 4406 /
NAS 1638

OUR PRODUCTS USAGE

- rubber extruders



- injection molding machines



- mechanical presses

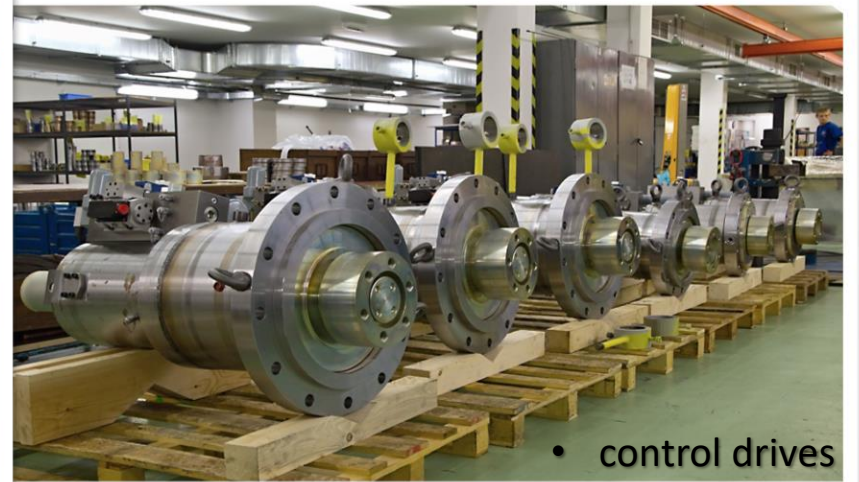

- control drives

OUR PRODUCTS USAGE

- lifting platforms



- agricultural machines



- construction machines - steering cylinders



- construction machines – tunnel drilling

MAIN INVESTMENTS IN 2024

- Friction Welding machine
- Deep Hole Boring machine



Supplier: MTI UK

Parameters: dia 30-100mm / length: 2000mm

Amount: 1.200.000,- €

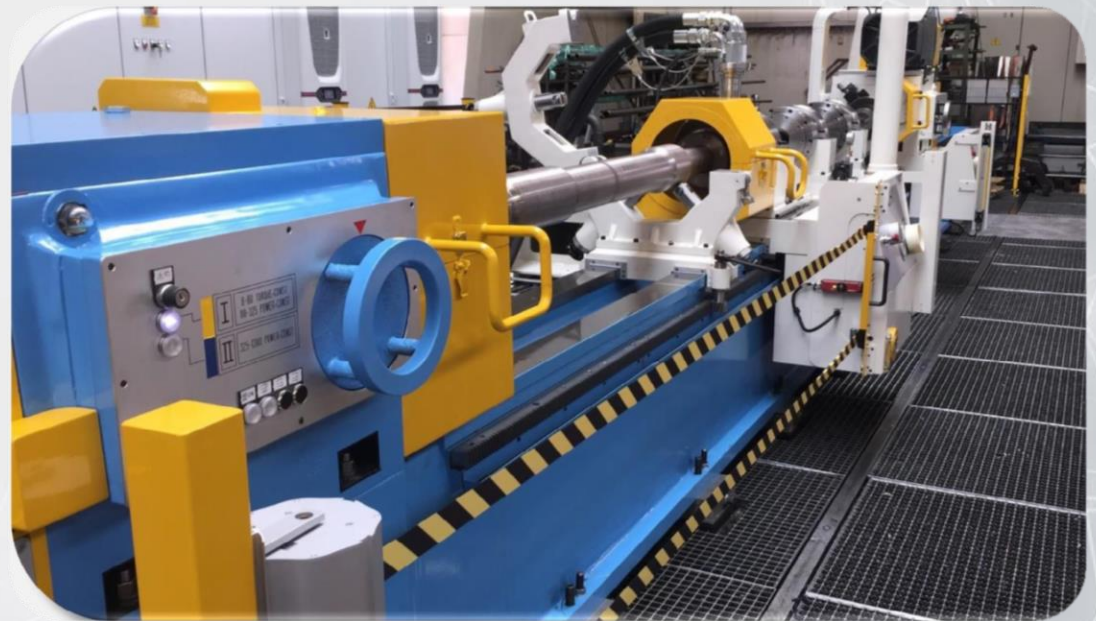

Supplier: TACCHI IT

Parameters: dia up to 200mm / depth: 3000mm

Amount: 920.000,- €

REFERENCES

- AMMANN compactors and finishers
- CLAAS agricultural machines
- HERBERT Maschinenbau hydraulic presses
- HMF hydraulic cranes
- CHARVÁT CTS hook loaders
- KRAUSS MAFFEI injection moulding
- LIEBHERR construction machines
- NIFTY LIFT lifting platforms
- SKODA DOOSAN energy machines and turbines
- VSG vehicle lifts

LIEBHERR



Krauss Maffei

AMMANN

HERBERT®
PARTNER FOR TIRE TECHNOLOGY & SERVICE WORLDWIDE

CLAAS



CTS lift

niftylift

The background of the slide is a light gray network pattern consisting of interconnected nodes and lines, resembling a molecular or digital structure.

CHARVÁT®

Thank you for your attention